

Abu Salabikh 1976



Abu Salabikh



List of garlic and onions: IAS 23

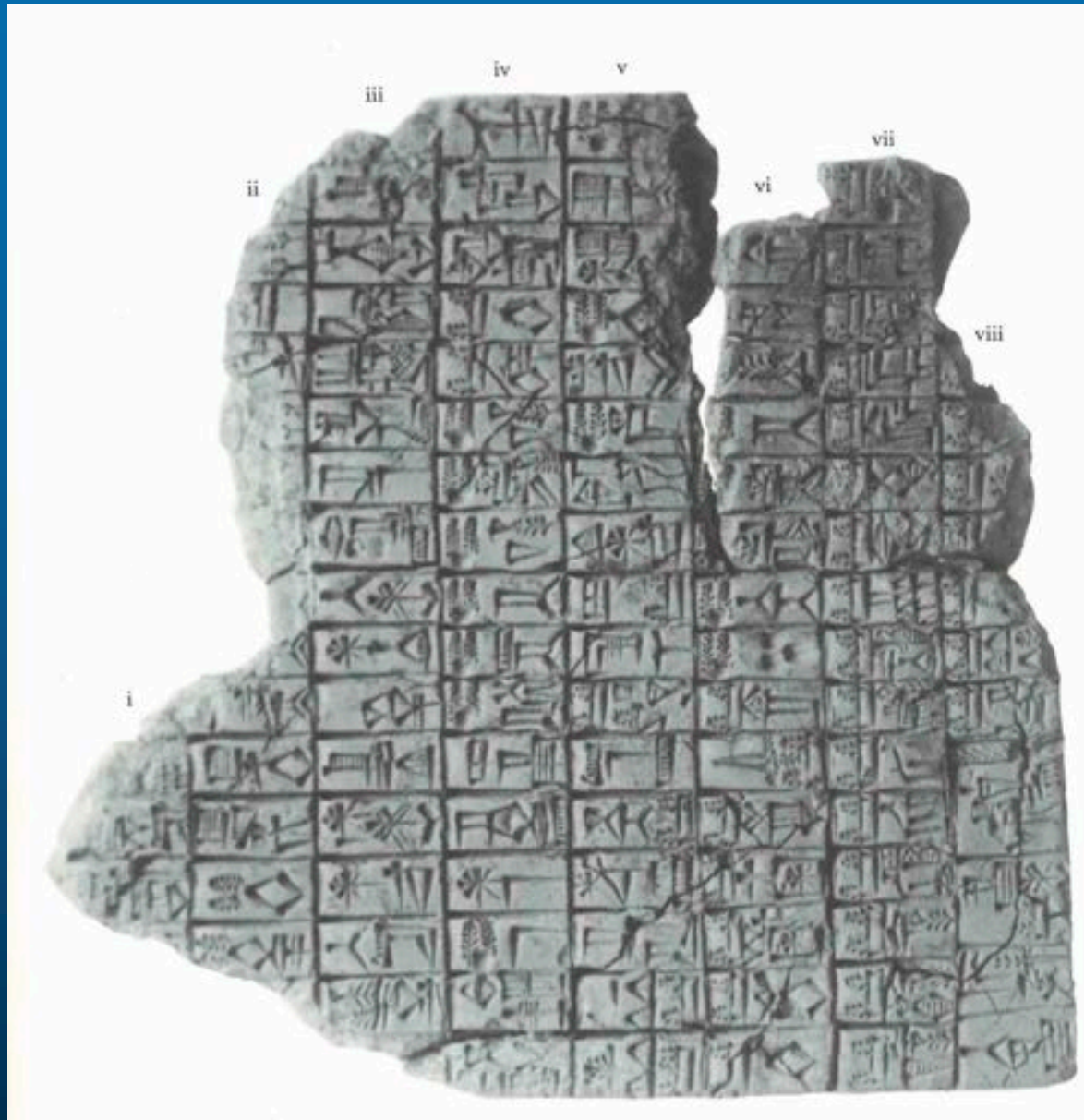

The list of professions

(R.D. Biggs, *Inscriptions from Tell Abū Ṣalābīkh, No. 1*)

1-17	18-34	35-51	52-68	69-85	86-102	103-19

The view from the BSAI roof over west Baghdad (1971)



Before the total station

Trigonometry 7 figure log tables

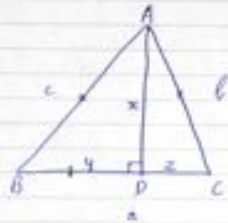

$$\frac{b}{a \sin B} = \frac{c}{a \sin C} \Rightarrow b = \frac{x}{c}$$

$$b \sin C = c \sin B \Rightarrow x = c \sin B$$

$$c = \frac{b \sin C}{\sin B} = \frac{a \sin C}{\sin B}$$

$$b = \frac{c \sin B}{\sin C} = \frac{a \sin B}{\sin C}$$

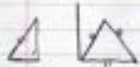

$L-CC = \frac{2c \cos 44^\circ 44' \cos 44^\circ}{\sin 49^\circ 04'}$	44° 62	8451642 1698997		49° 42	7995441 0758325
	51°	0810637 7794825	776.394	42°	0754236 2272106
$\log L-CC = 772.021$		2335814		$\log CC-CC$	2477130
$G-CC = \frac{2c \sin 49^\circ 33' 49'' \times 64}{\sin 77^\circ 04'}$	78° 66	7951921 1698997		36° 60-66	7767476 2477130
	77°	8650315 1794825	305.942	88°	0266806 9994143
242.768	$\log G-CC$	3255473		$\log G-HH$	0250663
$G-V = \frac{2c \sin 47^\circ 01' 30'' \times 66}{\sin 71^\circ 04'}$	47° 64	8043040 3255493		HH-CC -50-66	9992041 2477130
	70°	2497733 7735682	147.266	87°	1675171 9994143
128.923	$\log G-V$	2762845		$\log HH-CC$	1681028
$V-CC = \frac{2c \sin 44^\circ 44' 44'' \times 66}{\sin 70^\circ 04' 44''}$	44° 64	9495739 3255493		HH-L -50-66	8722924 1681028
	70°	3345032 7735682	192.267	42°	8722924 0405952
229.583	$\log V-CC$	3607354		$\log HH-L$	7287352 1214574
$V-DD = \frac{2c \sin 32^\circ 9' \times 66}{\sin 70^\circ 25' 14''}$	32° 60-66	9495739 3255493		L-CC -50-66	9264275 1681028
	66°	3345032 7735682	192.267	56°	1345301 7287352
238.573	$\log V-DD$	3376207		$\log L-CC$	2356043
$DD-CC = \frac{2c \sin 21^\circ 31' 01'' \times 66}{\sin 70^\circ 25' 14''}$	25° 60-66	6728040 3607354		CC-CC -50-66	9770264 2477130
	70°	7764434 7792292	233.190	40°	2277254 2580292
104.043	$\log DD-CC$	0172136		$\log CC-CC$	3677102
$DD-DE = \frac{2c \sin 48^\circ 33' 30'' \times 66}{\sin 53^\circ 11'}$	48° 60-66	7317908 0172136		CC-DE -50-66	6384325 2477130
	53°	7929094 7078973	206727	40°	2477130 2277254
109.970	$\log DD-DE$	0412751		$\log CC-DE$	0282920
$DE-CC = \frac{2c \sin 47^\circ 35' 30'' \times 66}{\sin 53^\circ 11'}$	47° 60-66	7677922 0172136		DE-DE -50-66	8592707 2477130
	73°	7830118 7078973	106676	89°	7946907 7667705
107.092	$\log DE-CC$	0752825		$\log DE-DE$	0280704
$DE-GG = \frac{2c \sin 40^\circ 22' 41'' \times 66}{\sin 42^\circ 14' 41''}$	40° 60-66	8265791 0752825		GG-DE -50-66	9600722 2477130
	42°	9624796 7078973	174.356	66°	0740667 2665903
136.386	$\log DE-GG$	1347670			1045665

The site from the east



AbS in 1973 from above and below

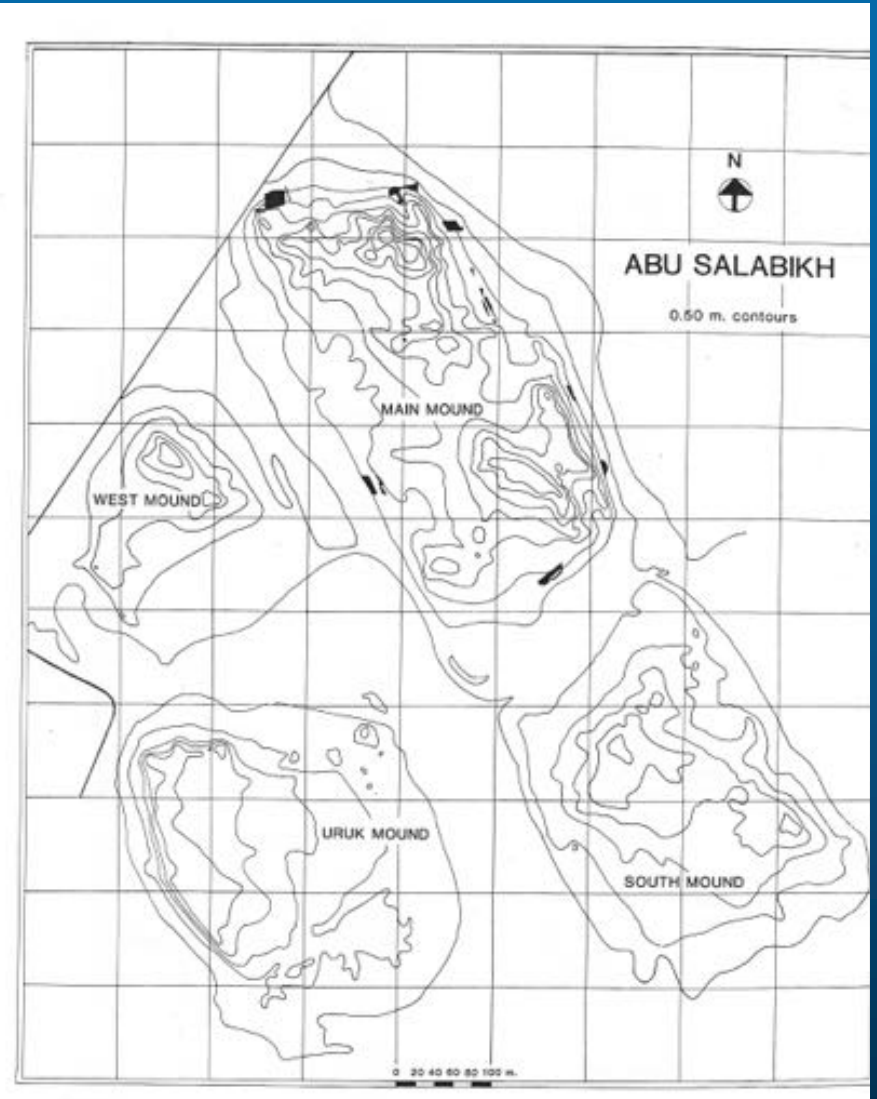
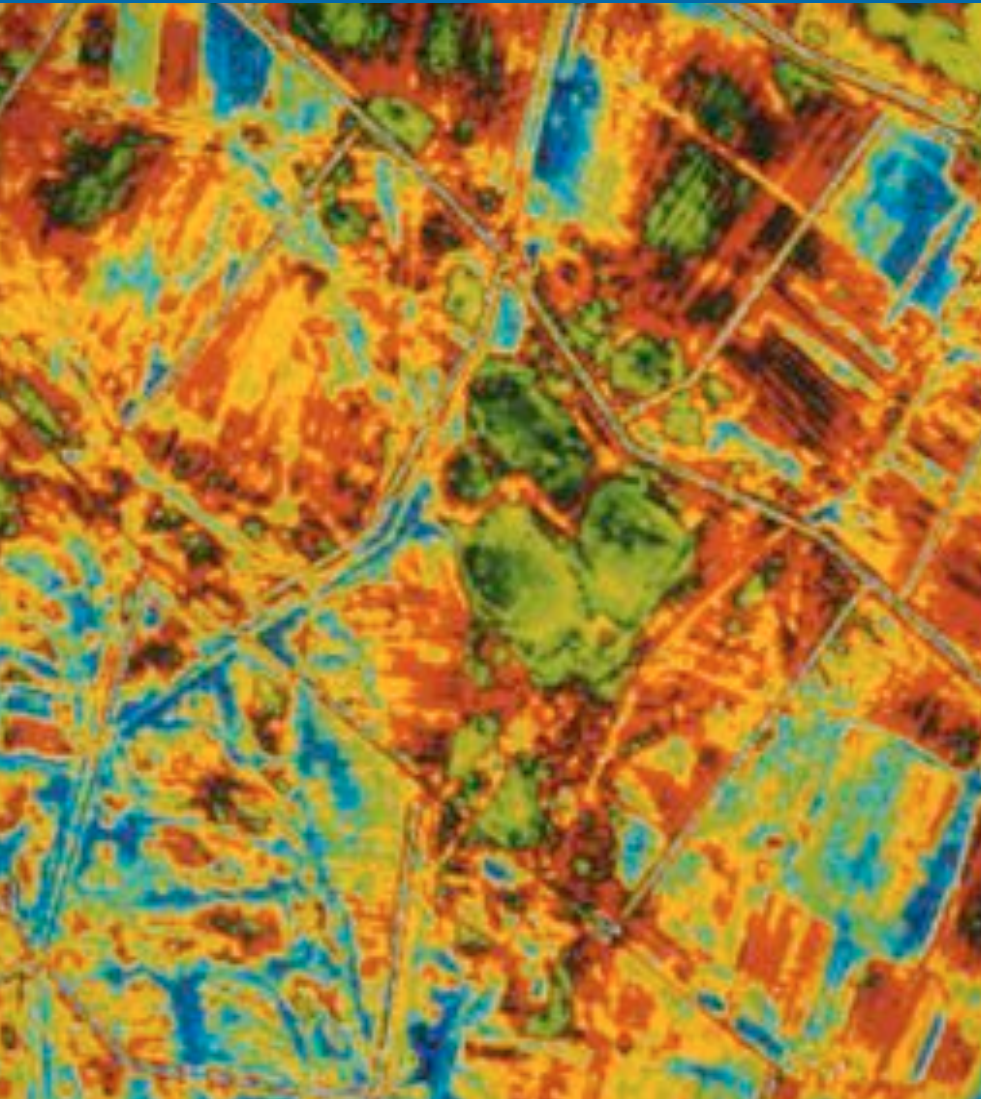

Visitors to the survey, 1973



Room 39, with Grave 1 in foreground



Grave 1

Grave 1, primary inhumation

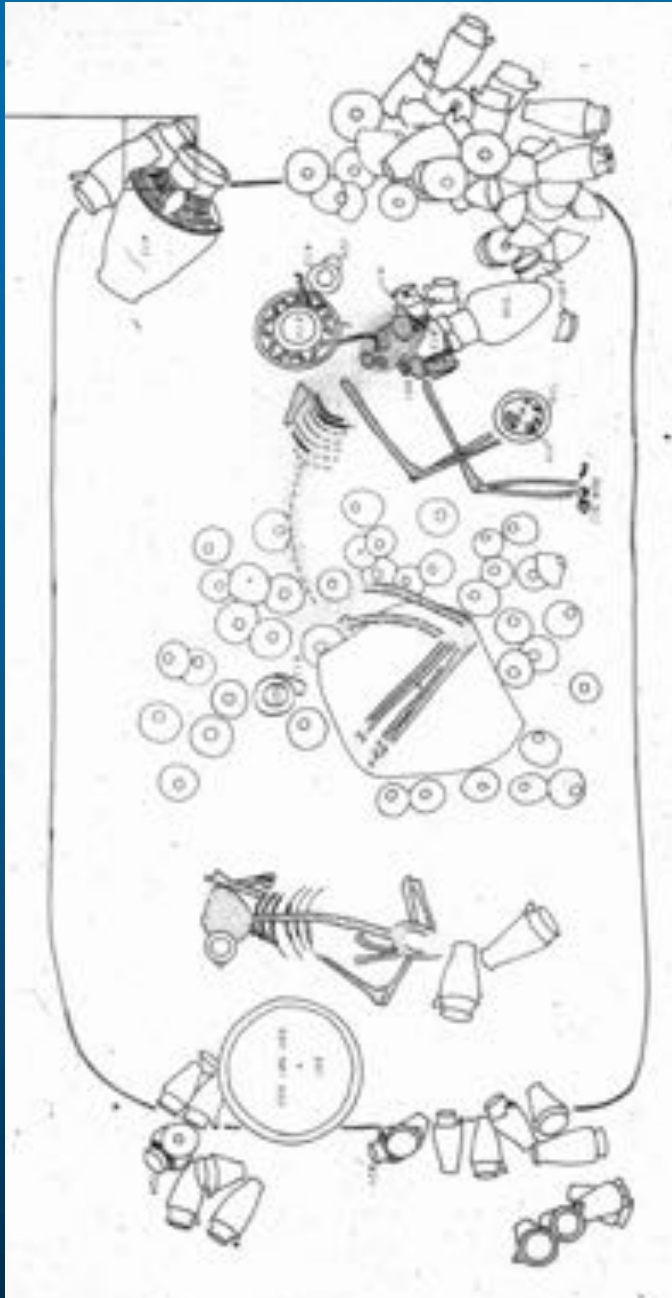

The pottery from Grave 1



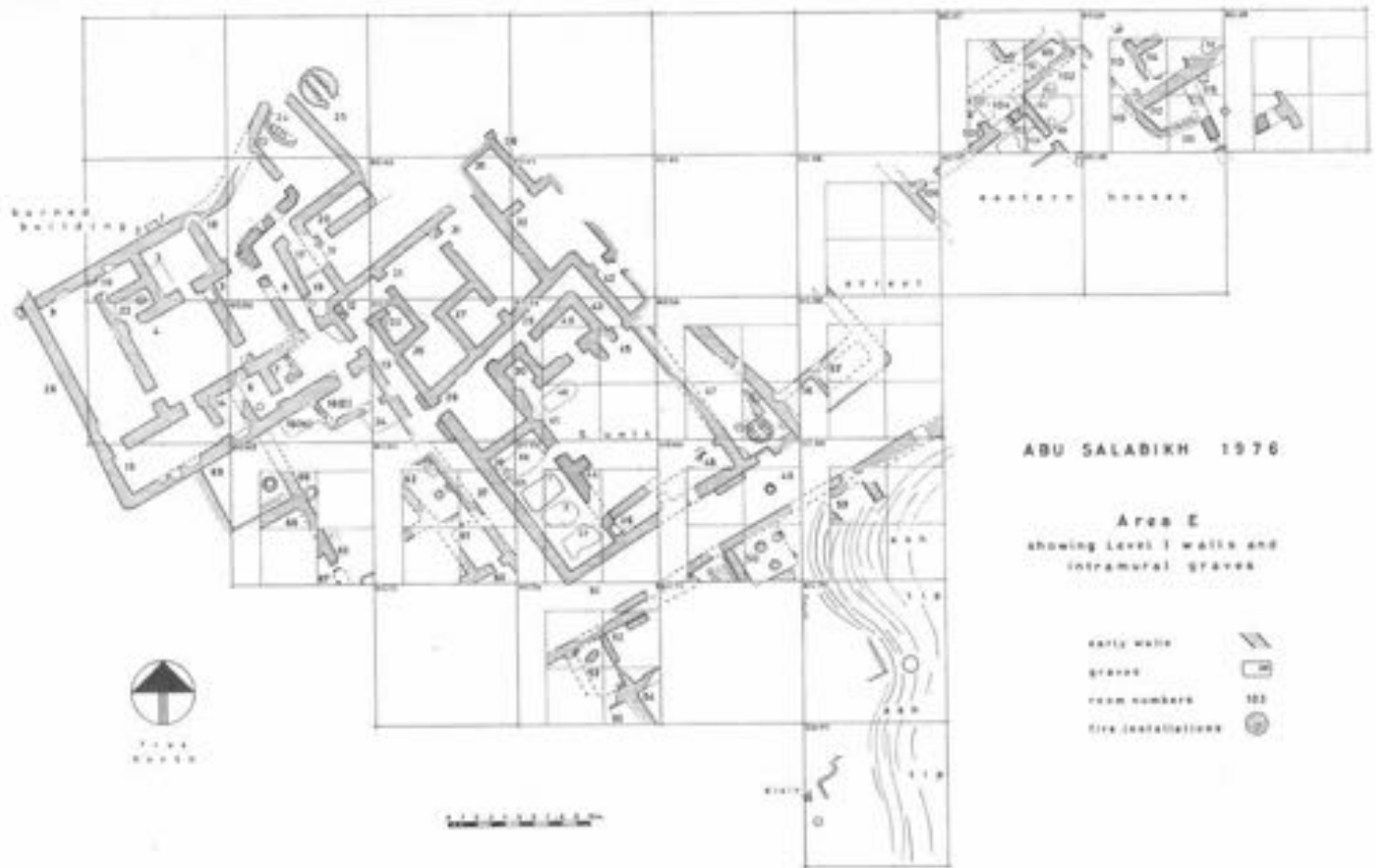

Fig. 3. Area E: plan of excavated area, 1963-76.

“our” tablets in situ



close up,
showing textile impressions



IAS 519: Account of sheep and goats

Grand total: 13,972



Rev.

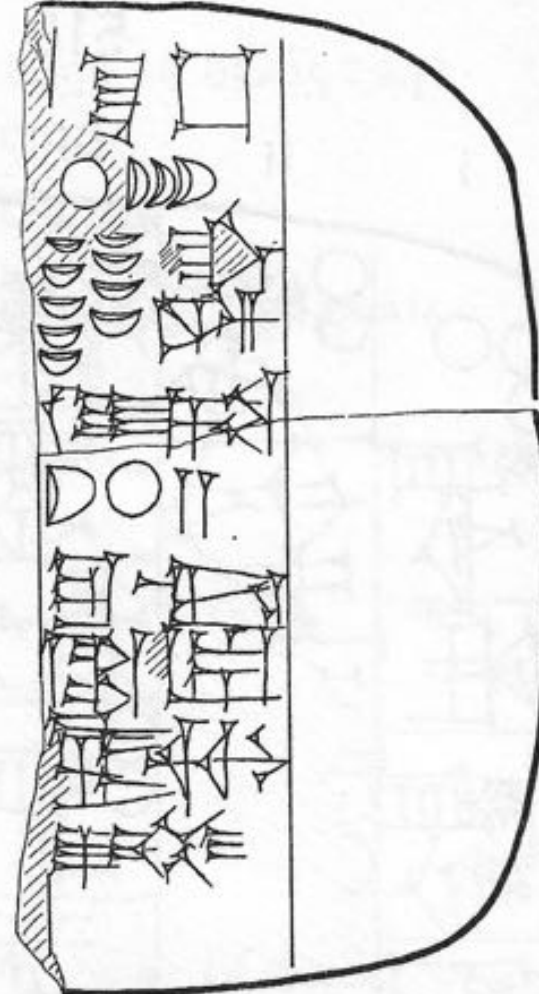

Allocations of field prebends (IAS 518)

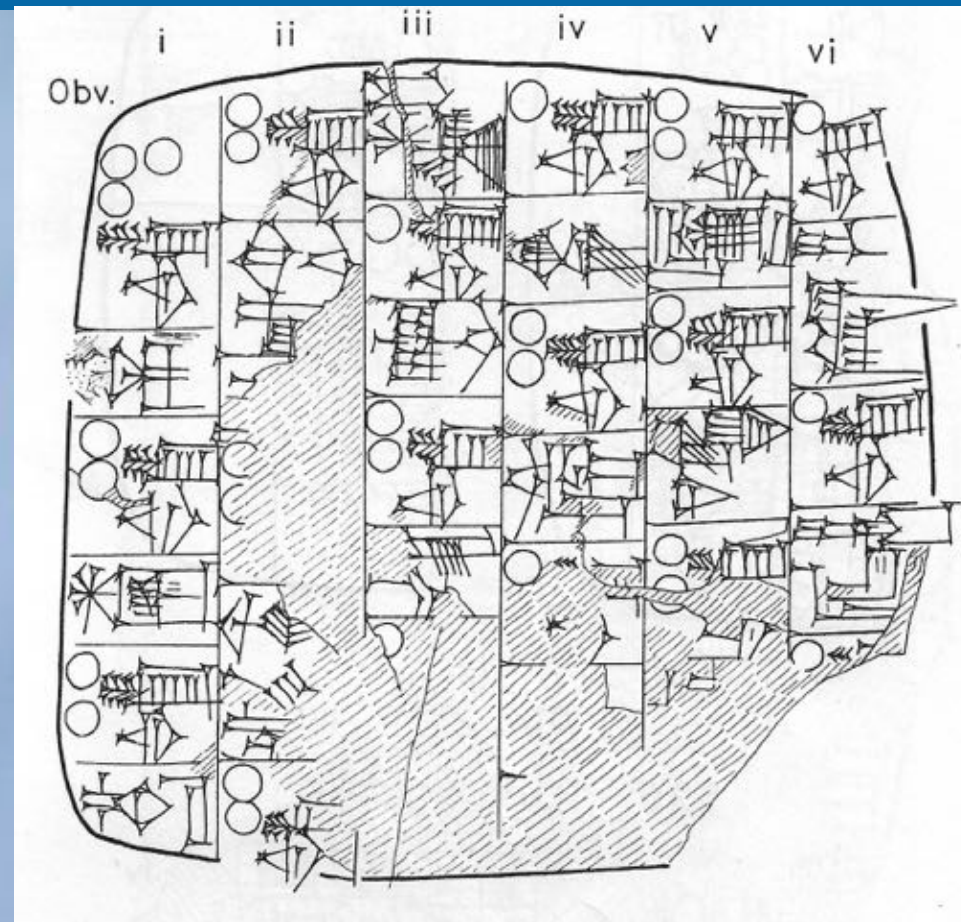

Tip lines SE of building



Clay sealings from Ash-Tip

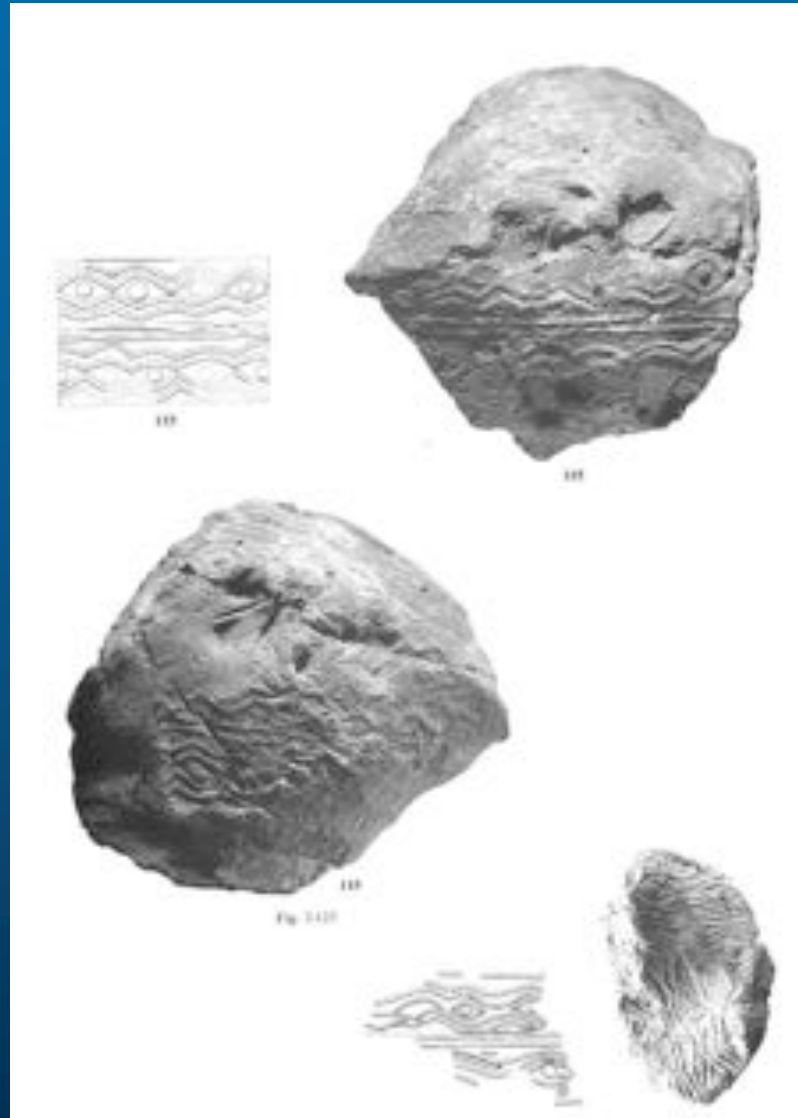

Animal figurines from Ash Tip



Human figurines from Ash Tip



Miniature jars from the Ash Tip



Pottery discs from the Ash Tip



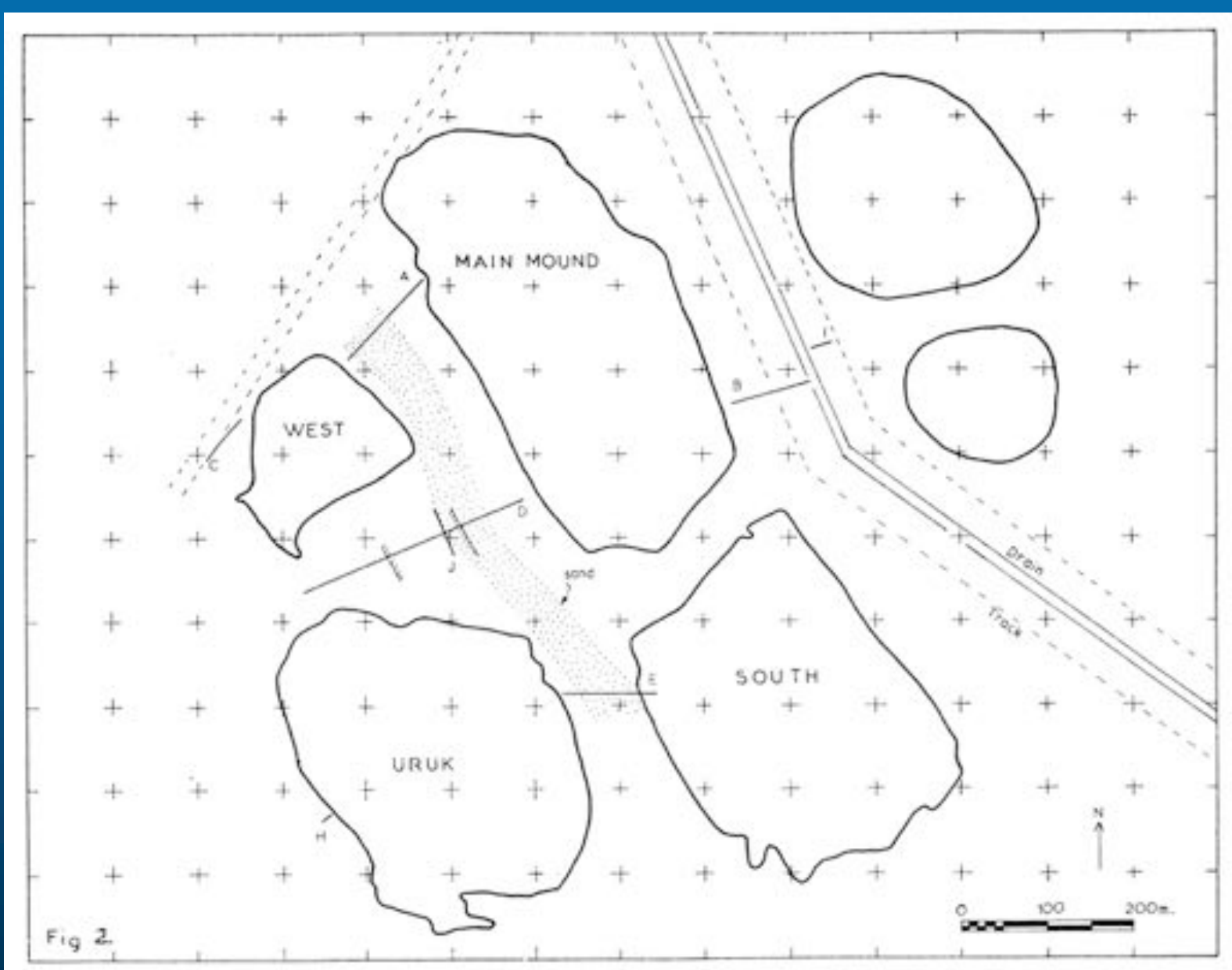

Fig 2.

Surface clearance, West Mound



The bipod





West Mound after clearance and after planning



Tony Wilkinson augering (1986)



TJW extracting and inspecting the core



The watercourse between mounds

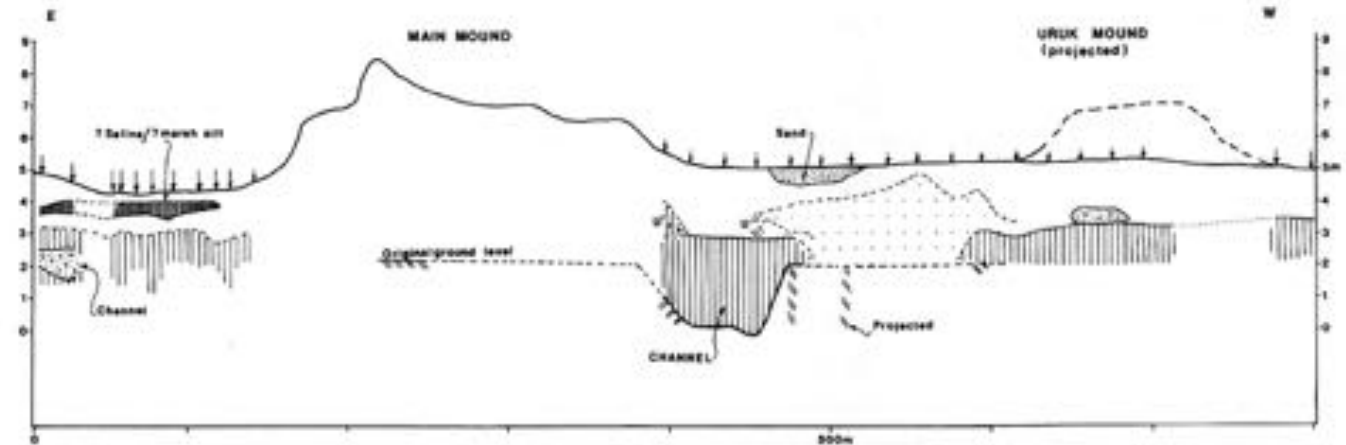
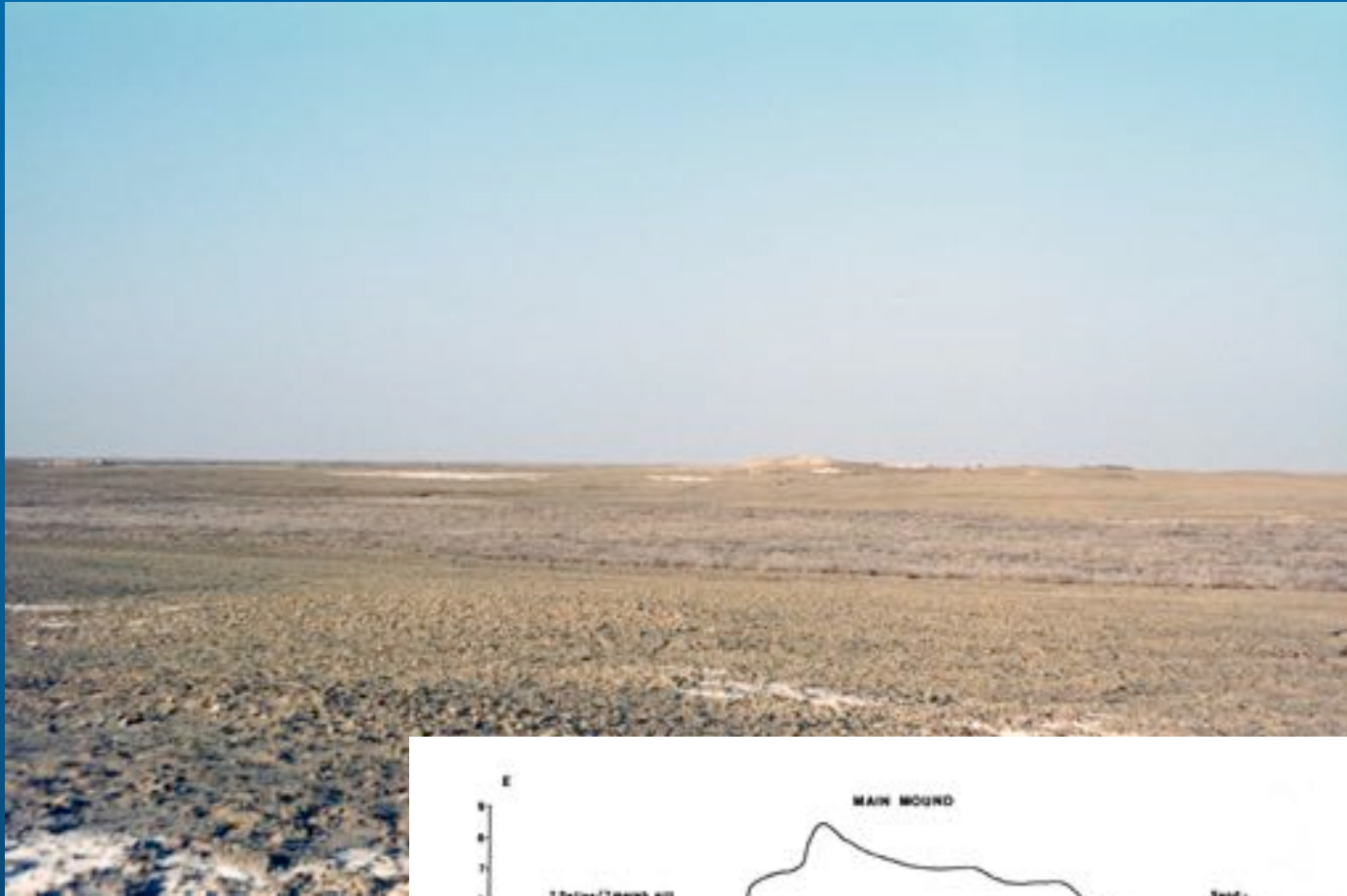

Sites and watercourses north of Nippur

(Adams, Heartland)

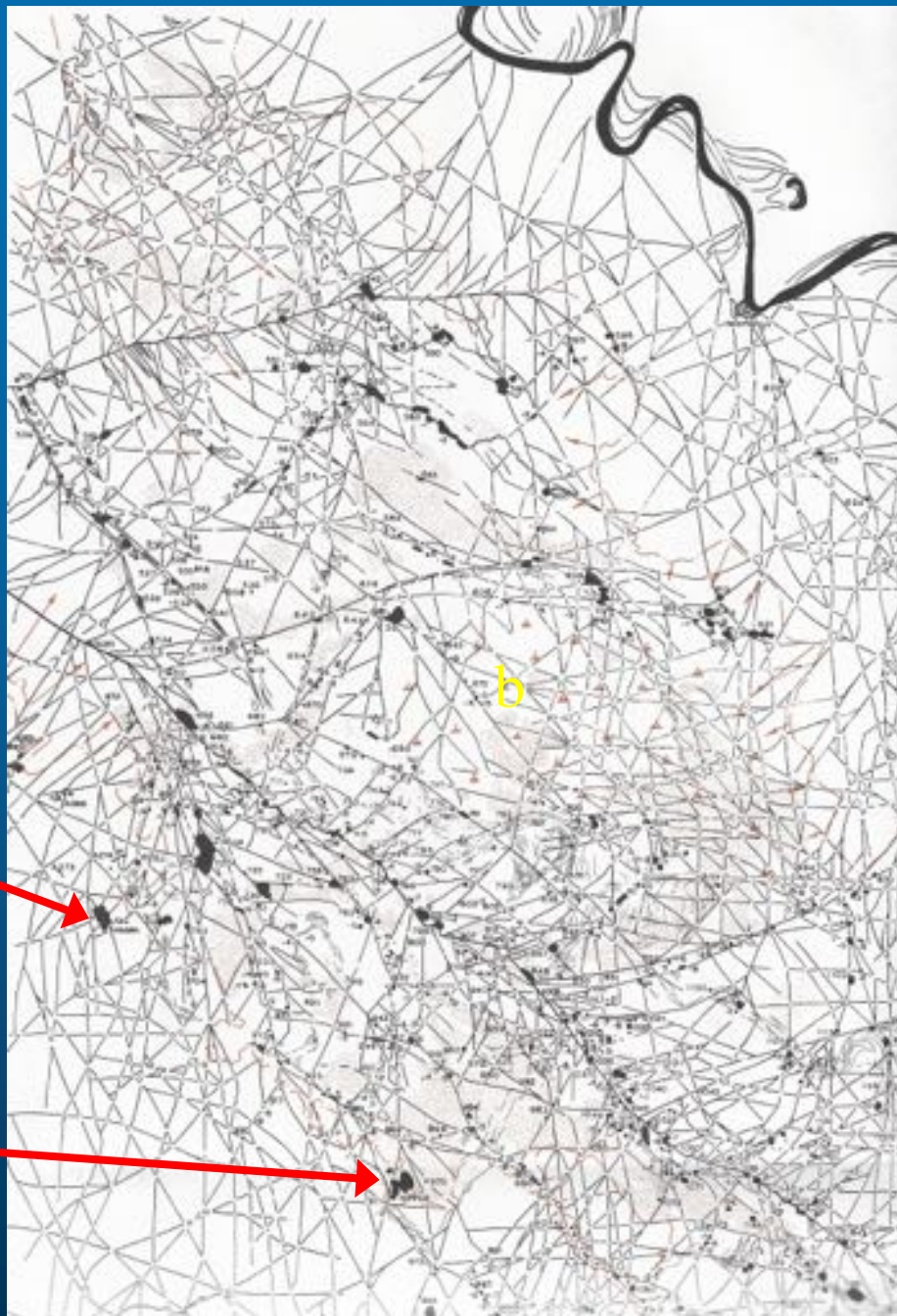

Abu Salabikh

Nippur

What does it cost to go down 1 metre? (1980 prices)

1m sounding	1x1x1m	1 m ³	£75
10 m square	10x10x1m	100 m ³	£7,500
1 hectare	100x100x1m	10,000 m ³	£750,000
Main Mound	100x100x10m	100,000 m ³	£7,500,000



Judicious spraying brings out the colours



“gubale” elicits unwonted zeal



Roger and Heather scraping



5G63 surface plan- 1:50

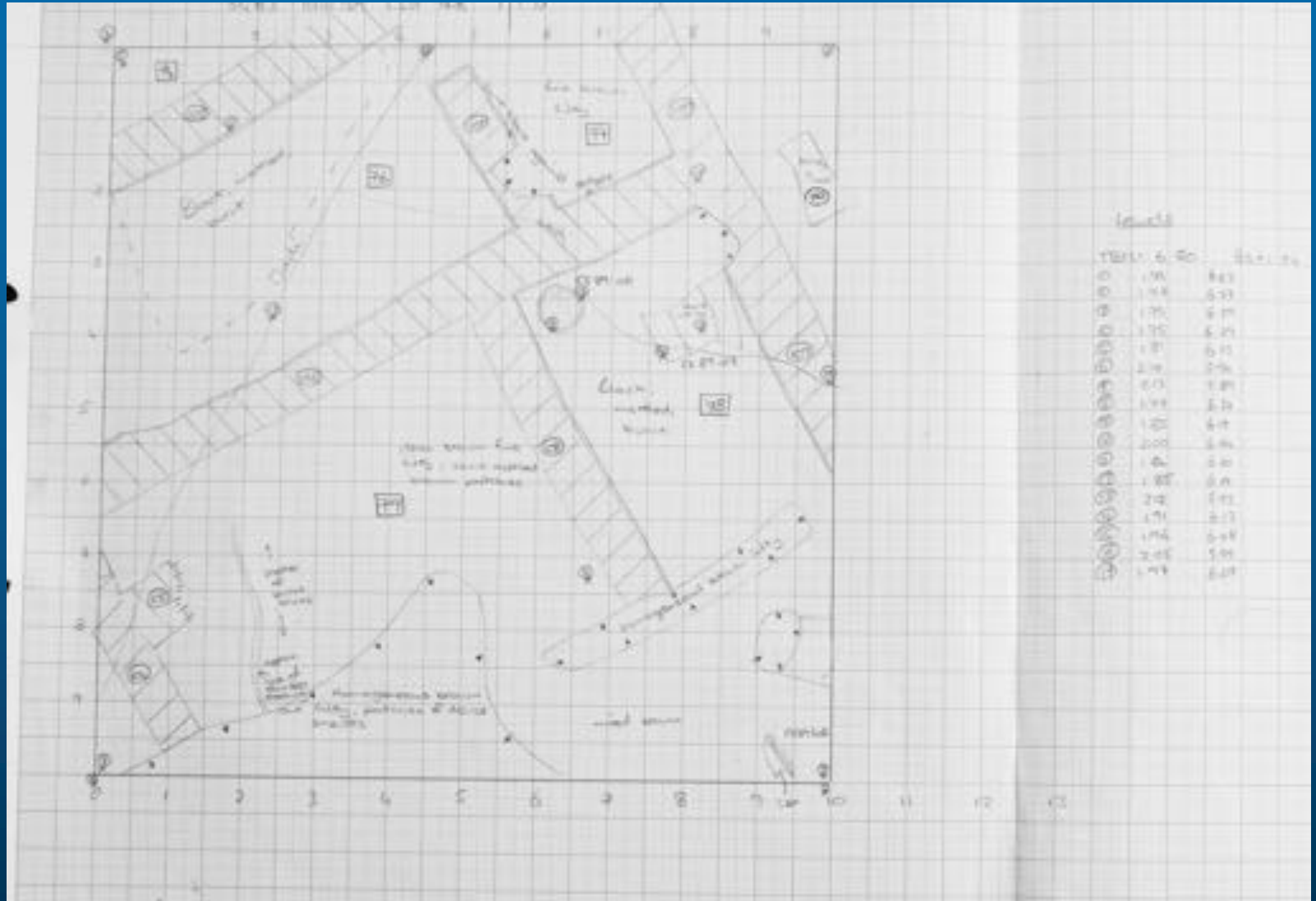

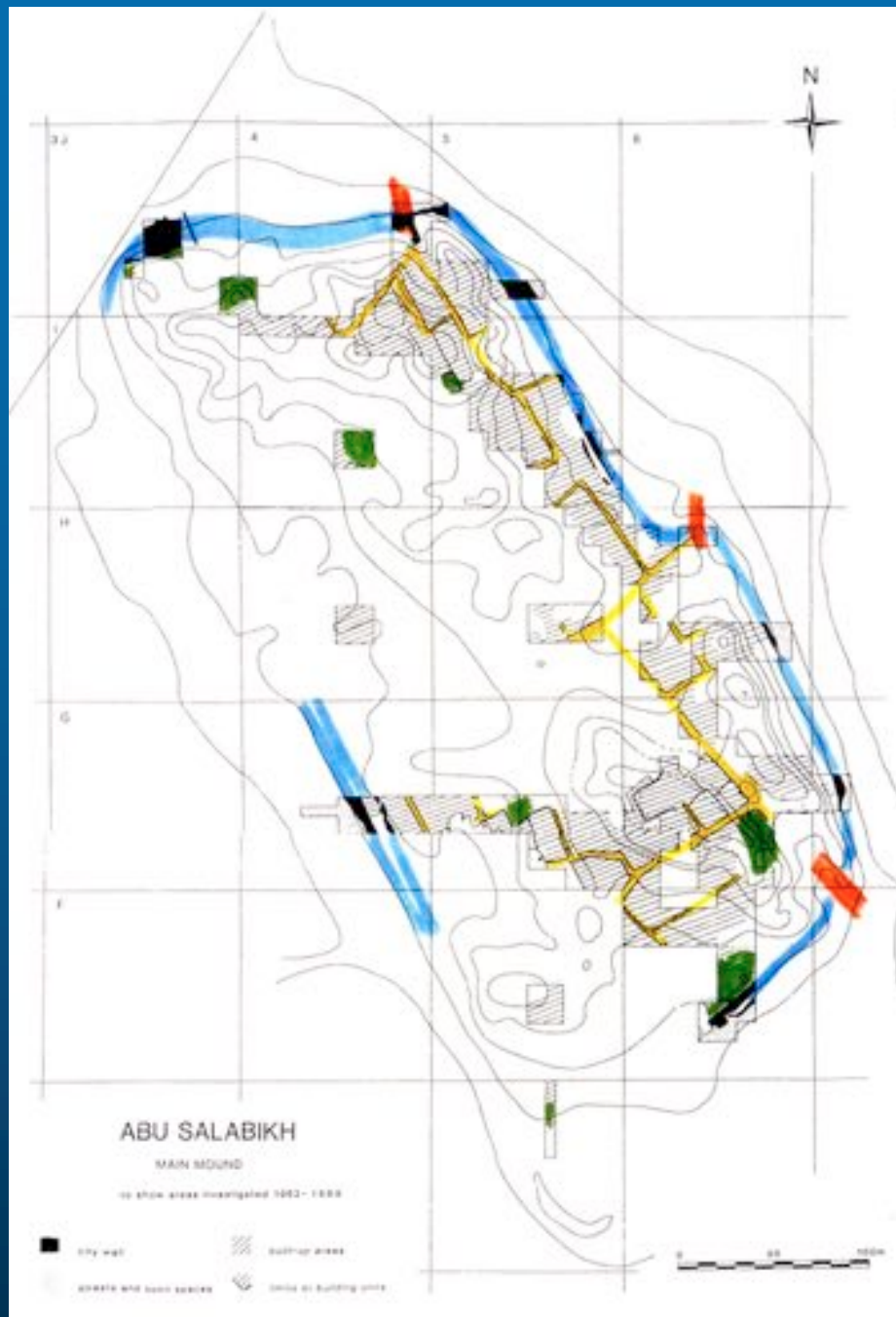

**The city wall,
north end**
(flattened!)





The site
from space
2003

(not snow, salt)

6H House

5G House

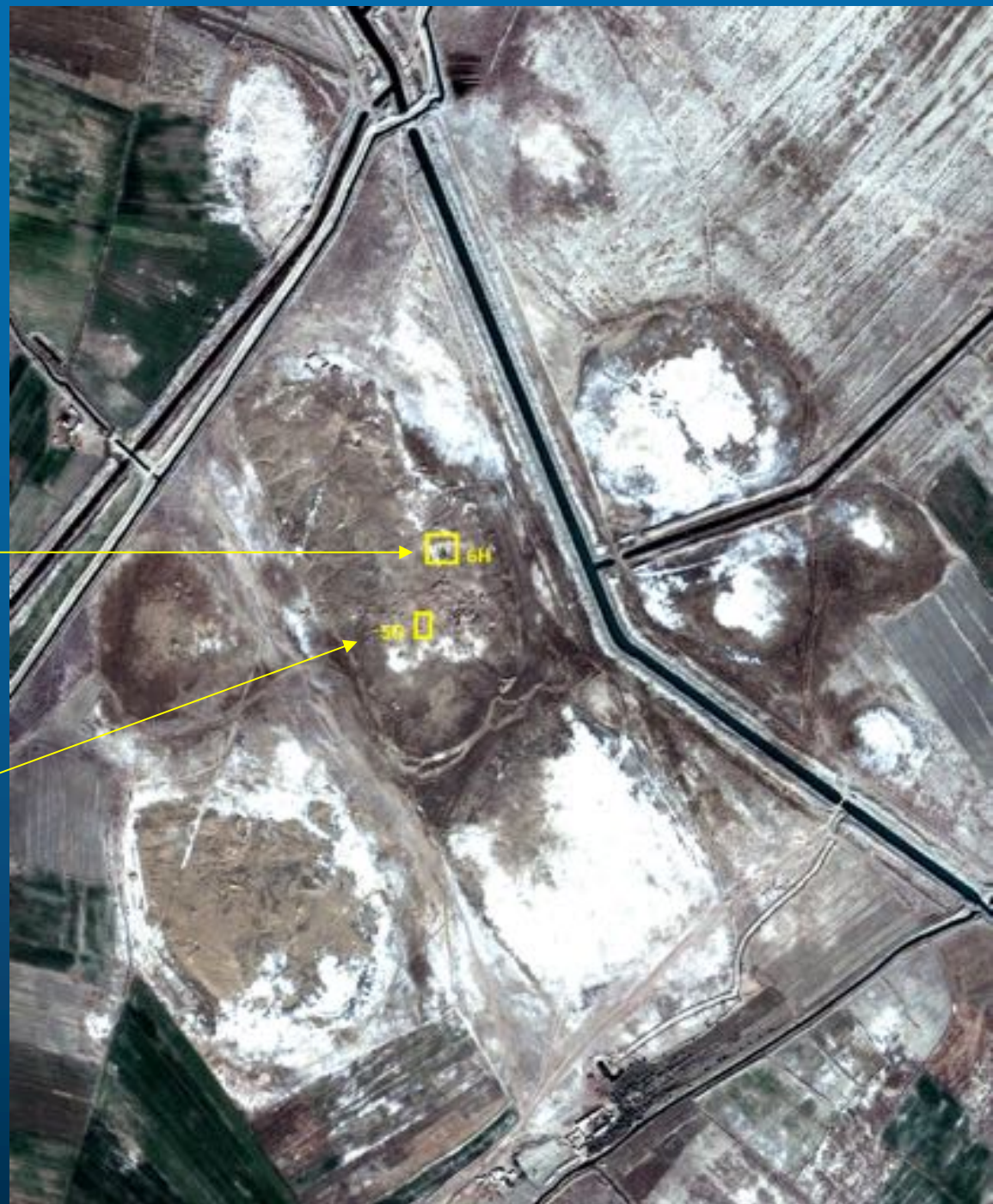

Main Mound SE quarter

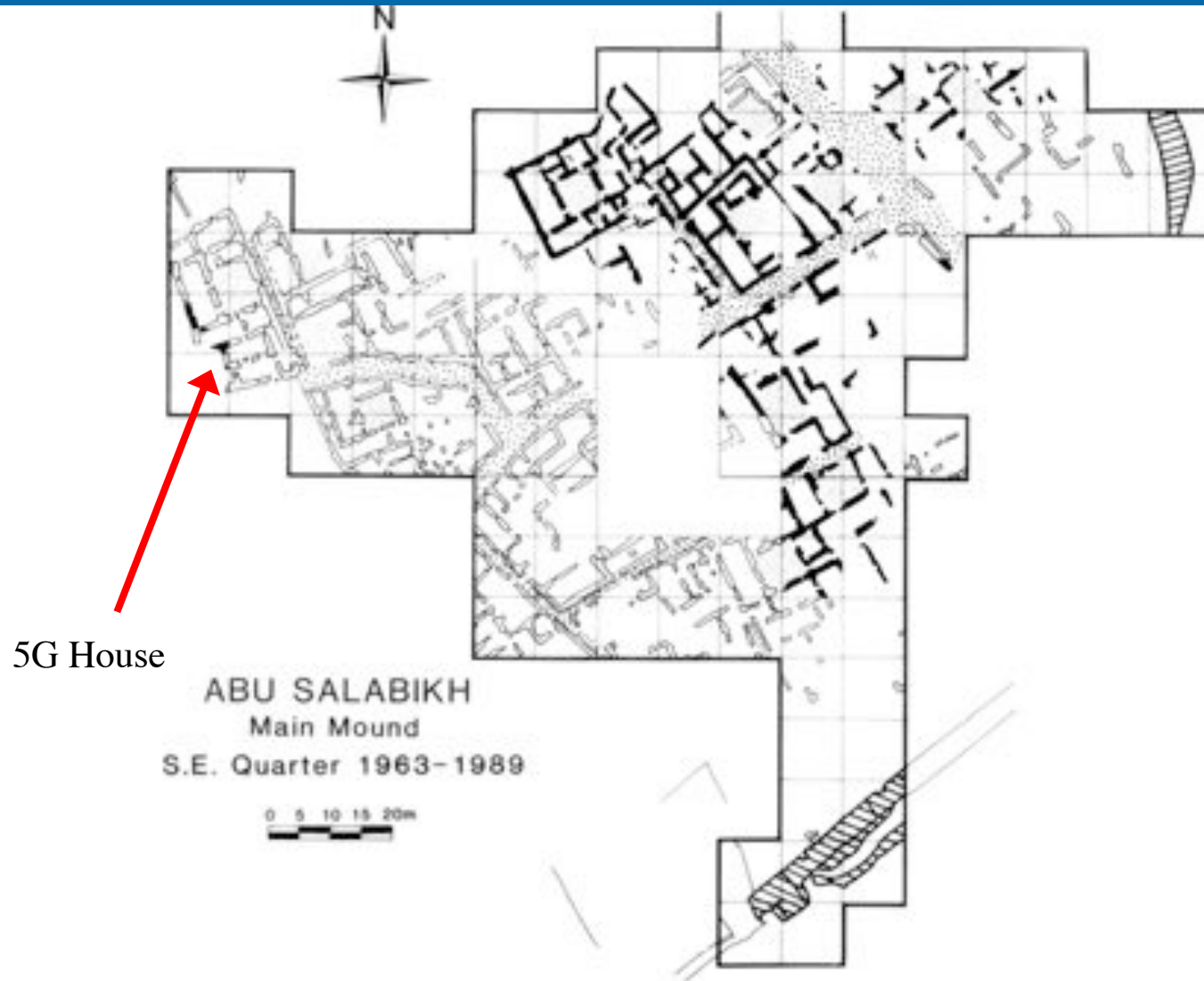

5G House, ca. 2400 BC

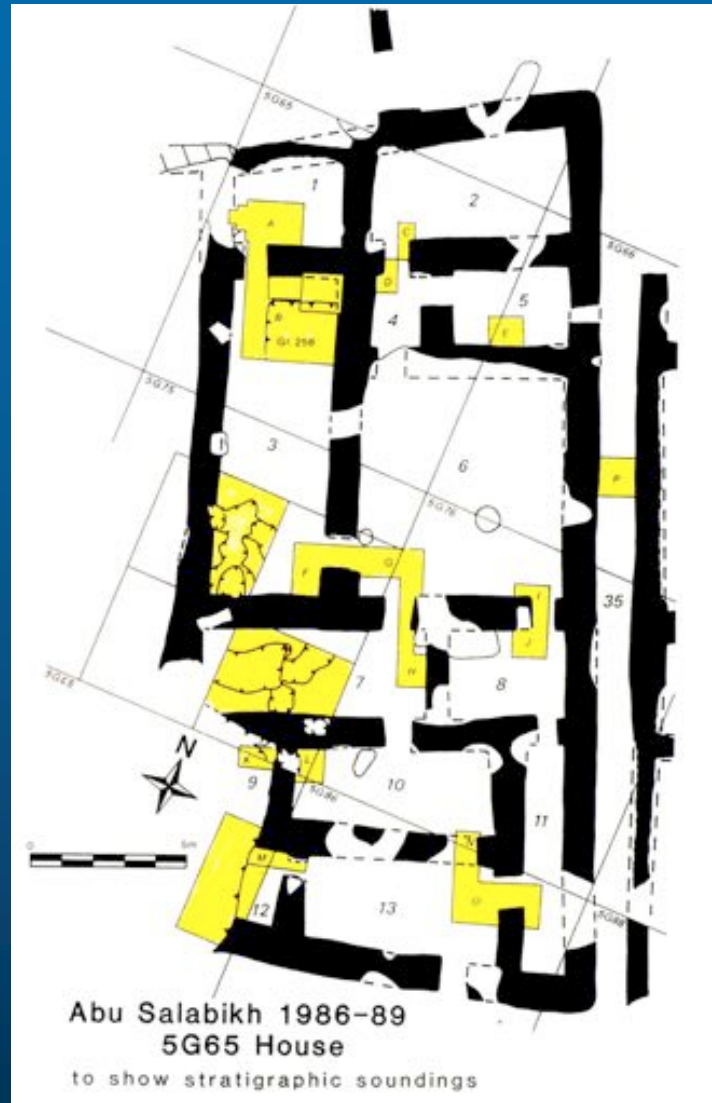

The micromorphologist at work

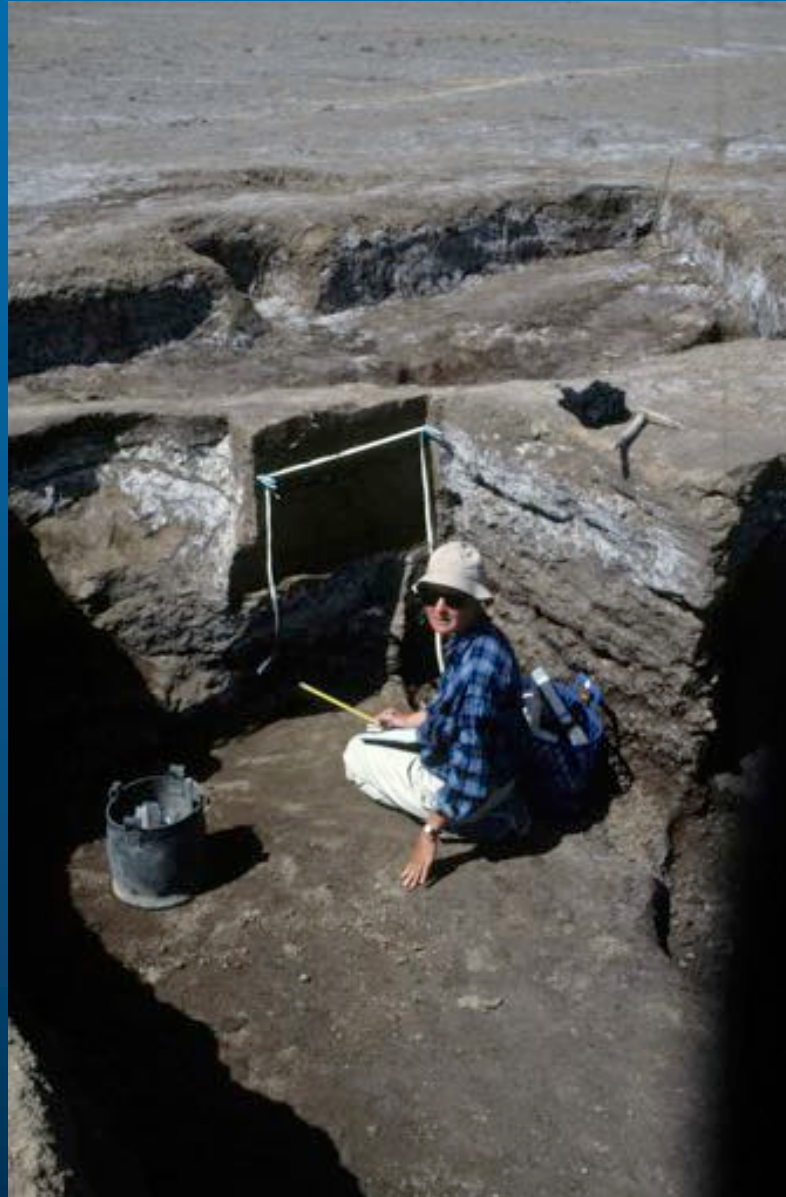

Sample of successive room floors



Courtyard accumulations, under the microscope

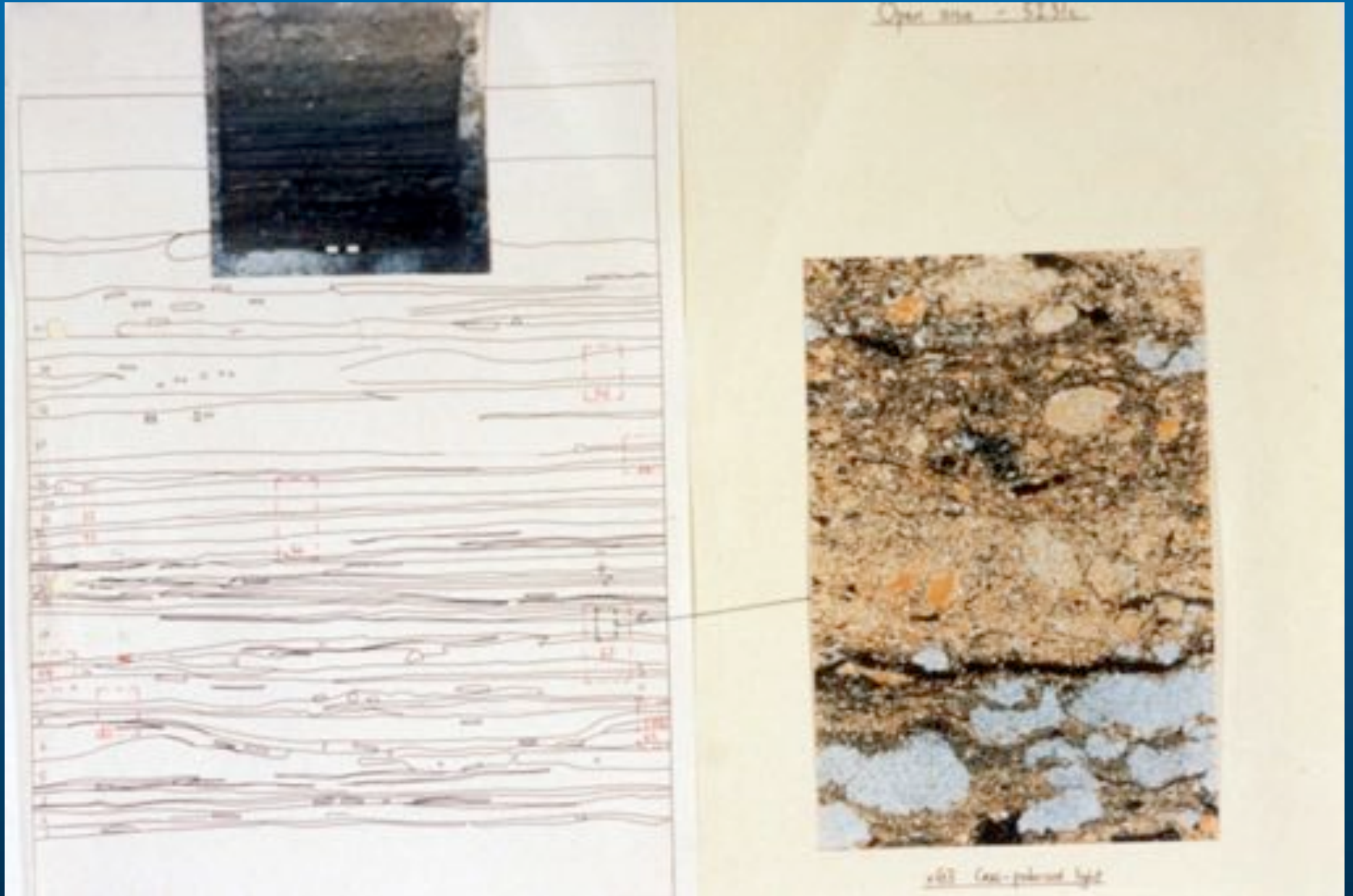

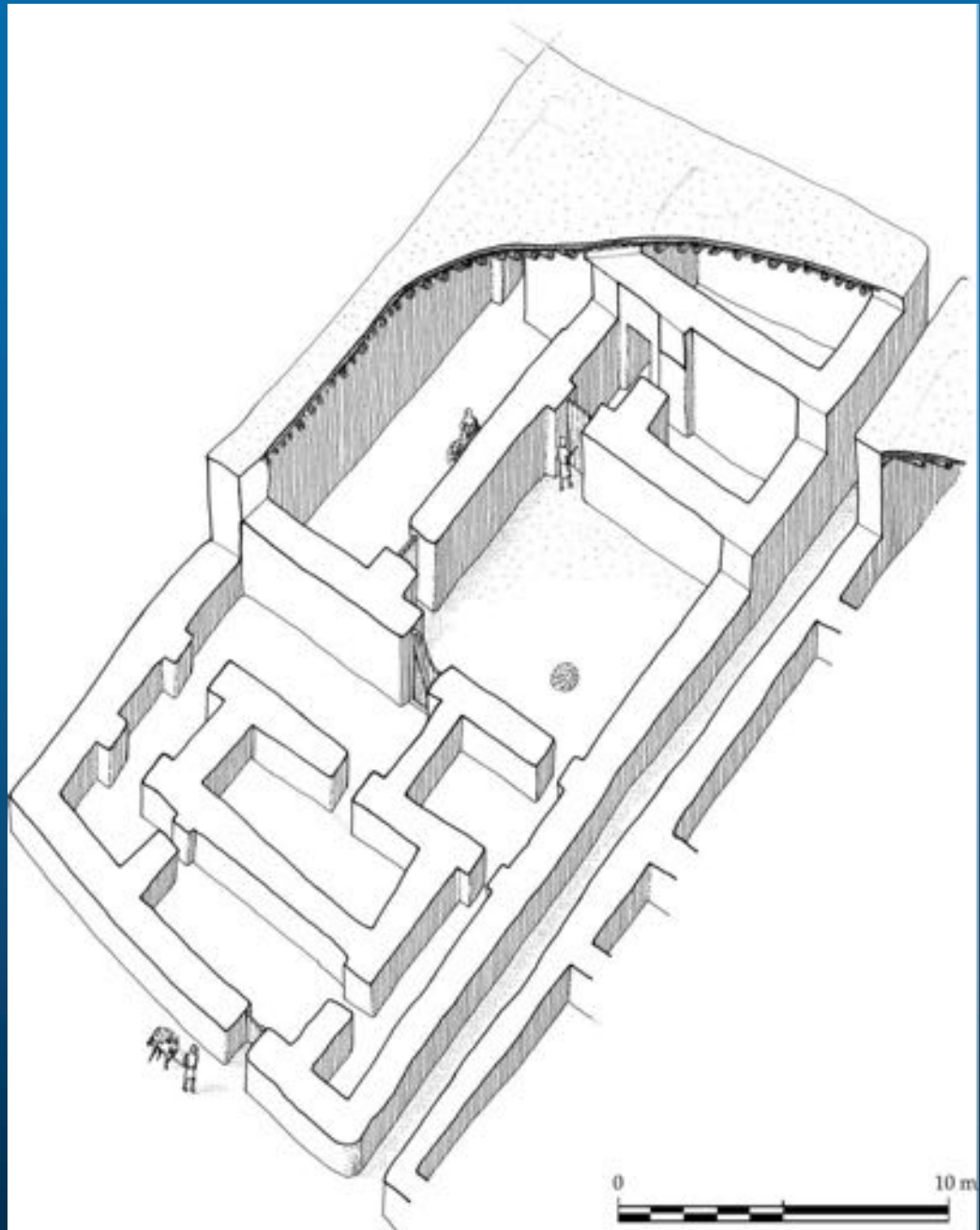

5G House, ca. 2400 BC

Room I
shrine

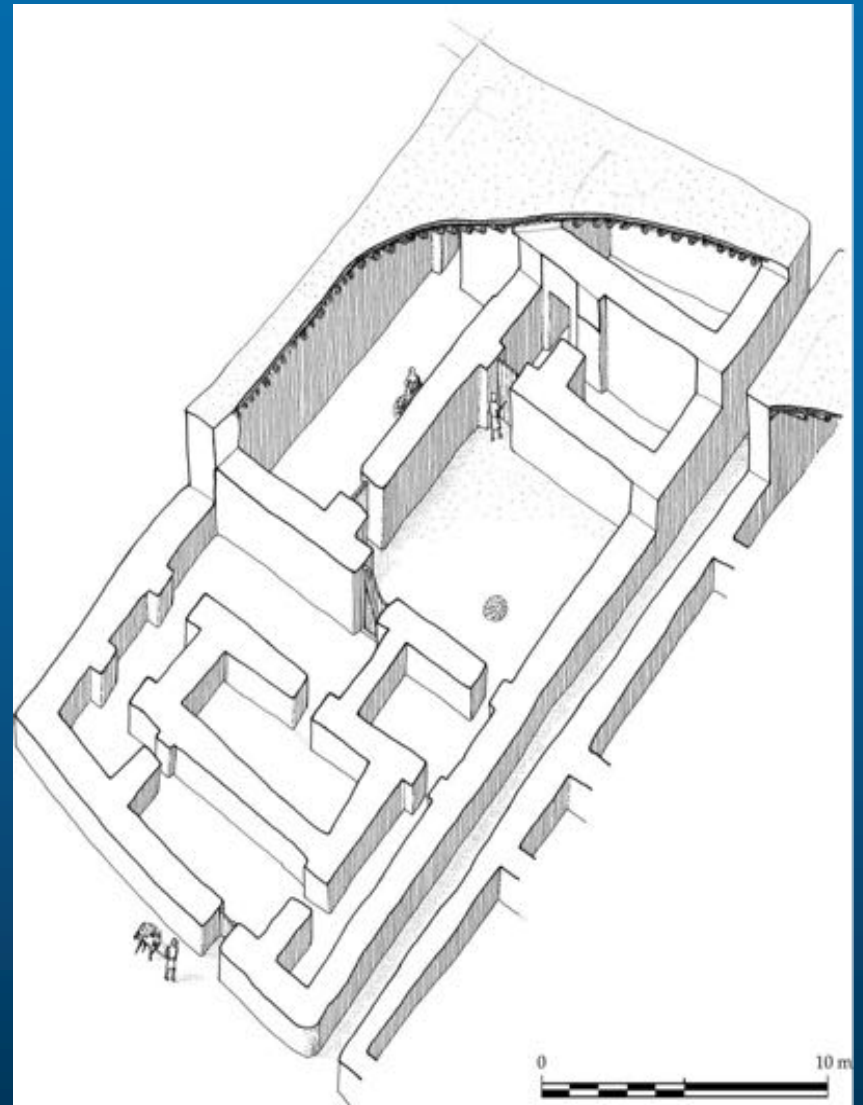
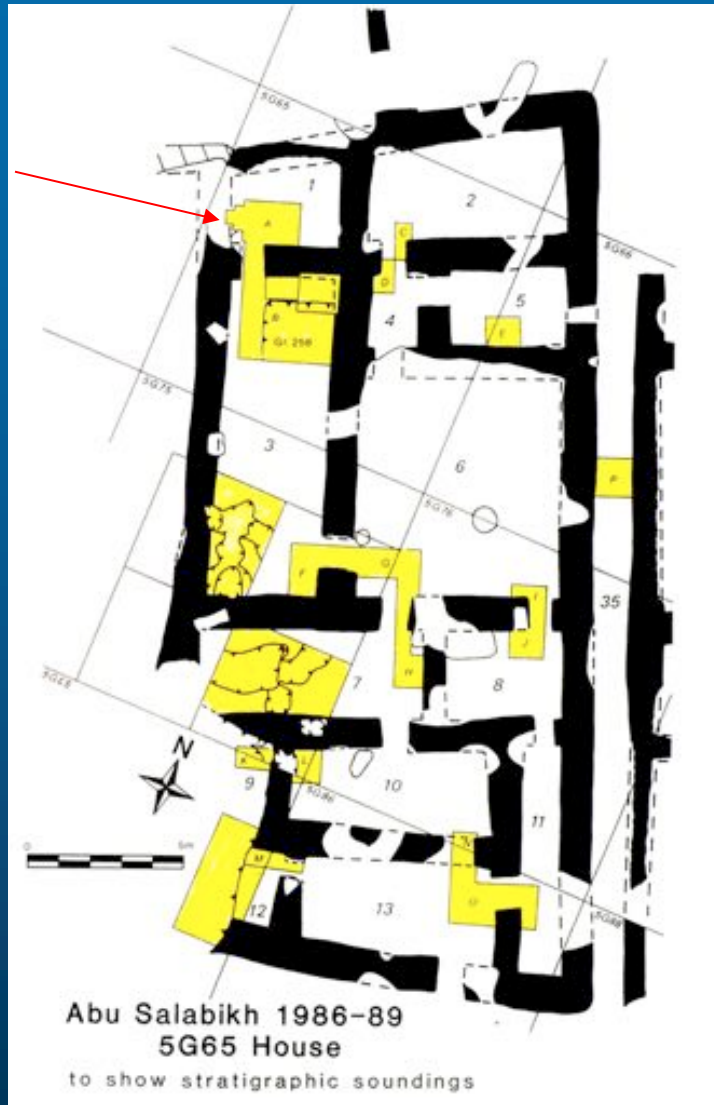

Clay animals from the 5G House - 1989



The 6H House (Level IC)



Grave 234
Paul Croft in NW corner



Grave 234

jewellery

equid ribs

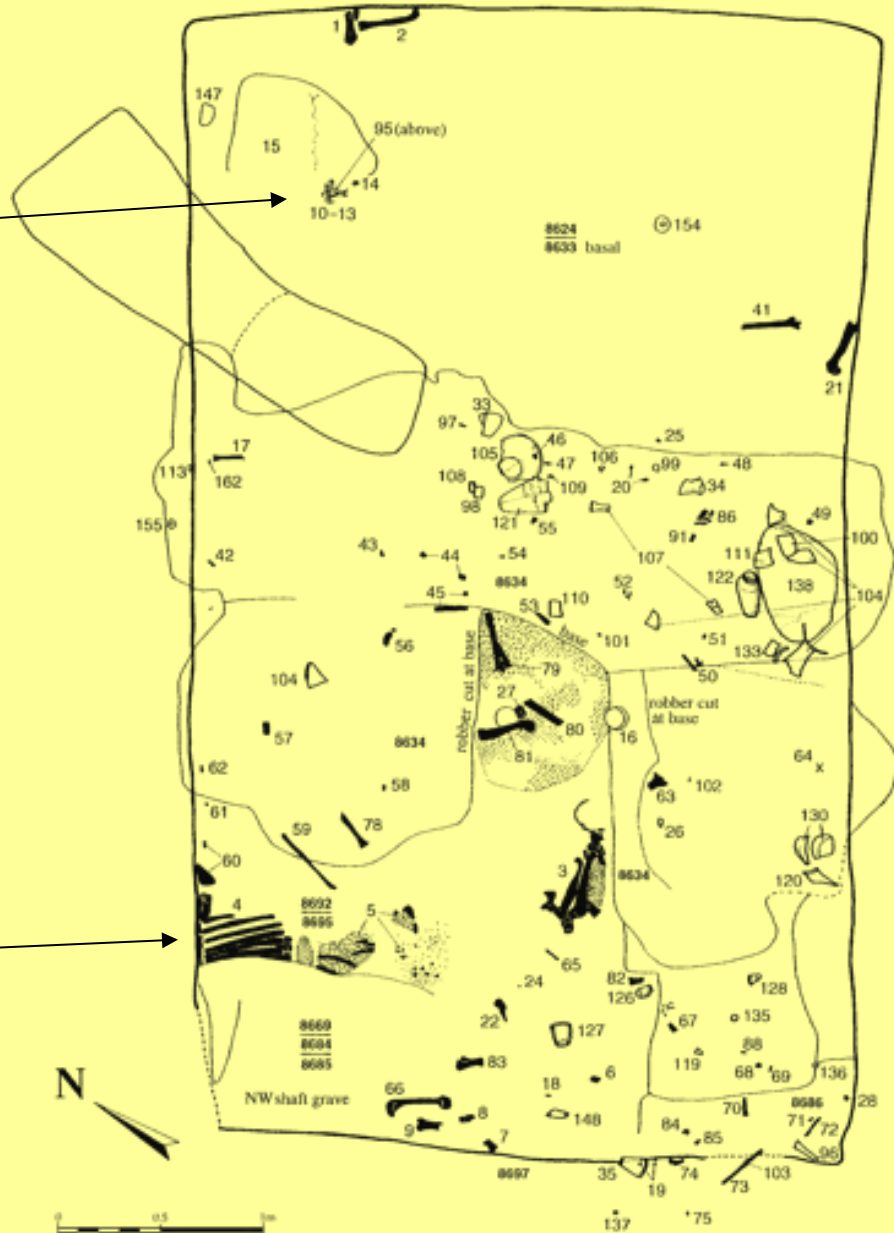

Grave 162: the transport compartment



The "Standard of Ur"

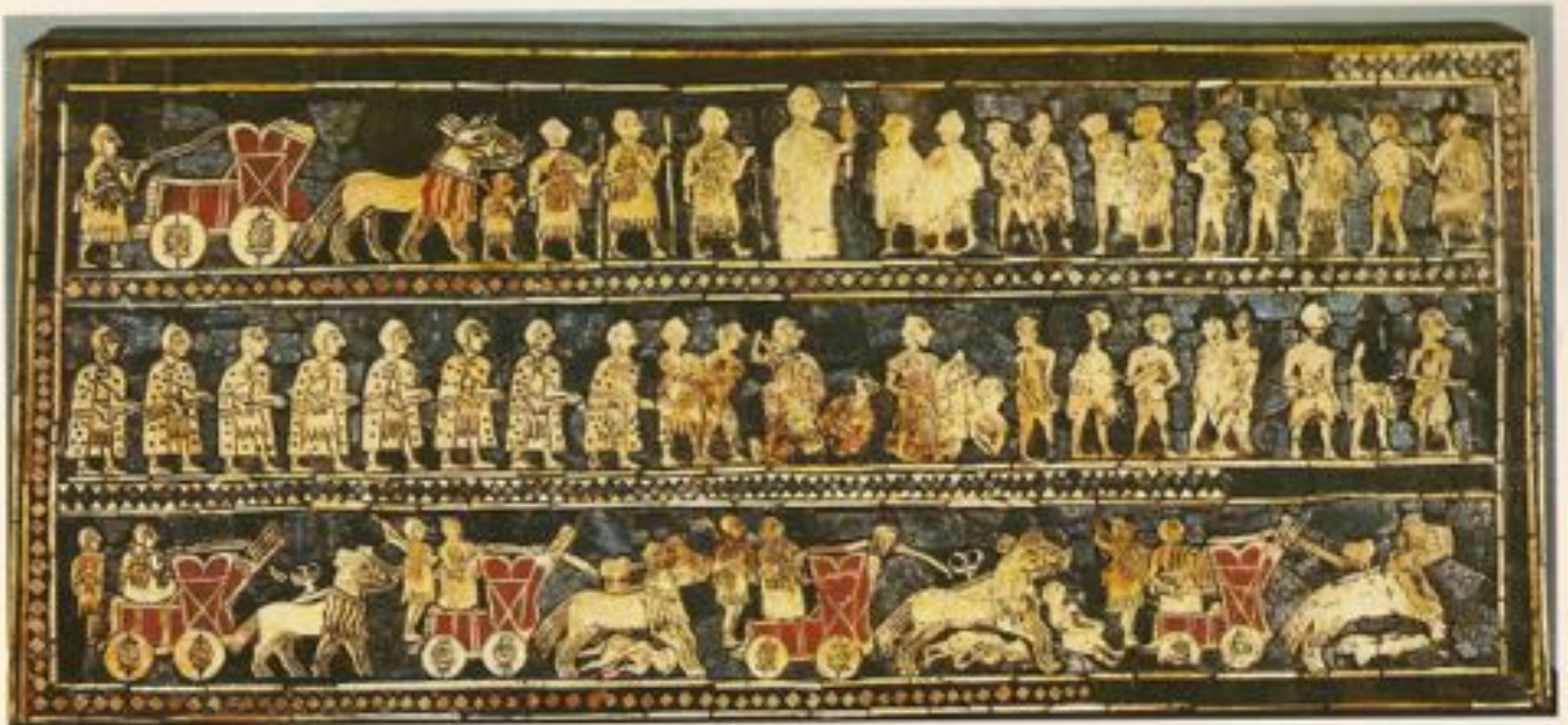

VIII. Seg. Mesakistandarte, aus Ur, Irak, frühkalamitisch, um 2600/2500 v. Chr.; London

Onager hybrids at the zoo
(Schönbrunn)



Jewellery and cosmetic shells in Grave 234



The jewel bag from Grave 234



6H House, Level IB

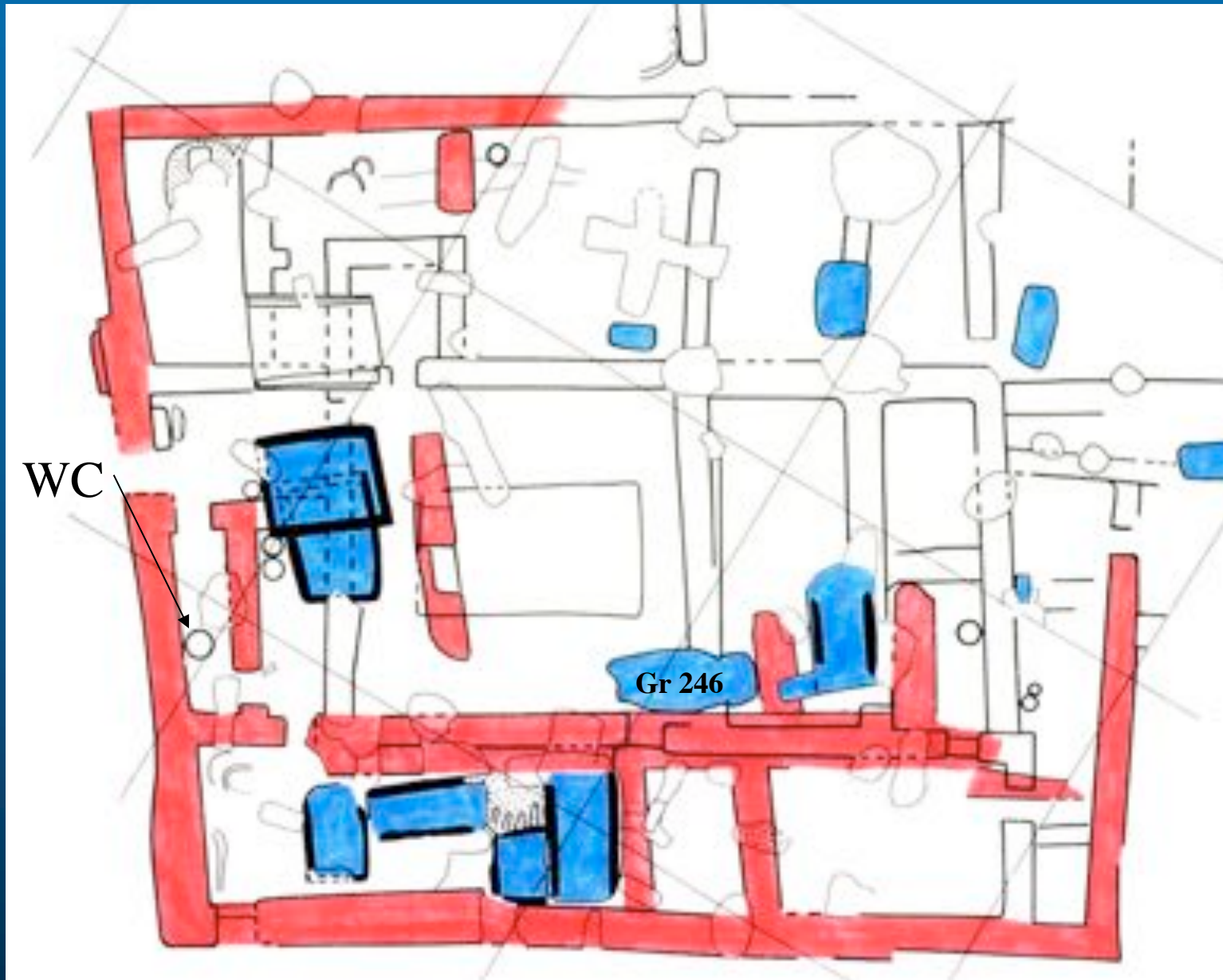

Grave 246
occupants in situ



Grave 246

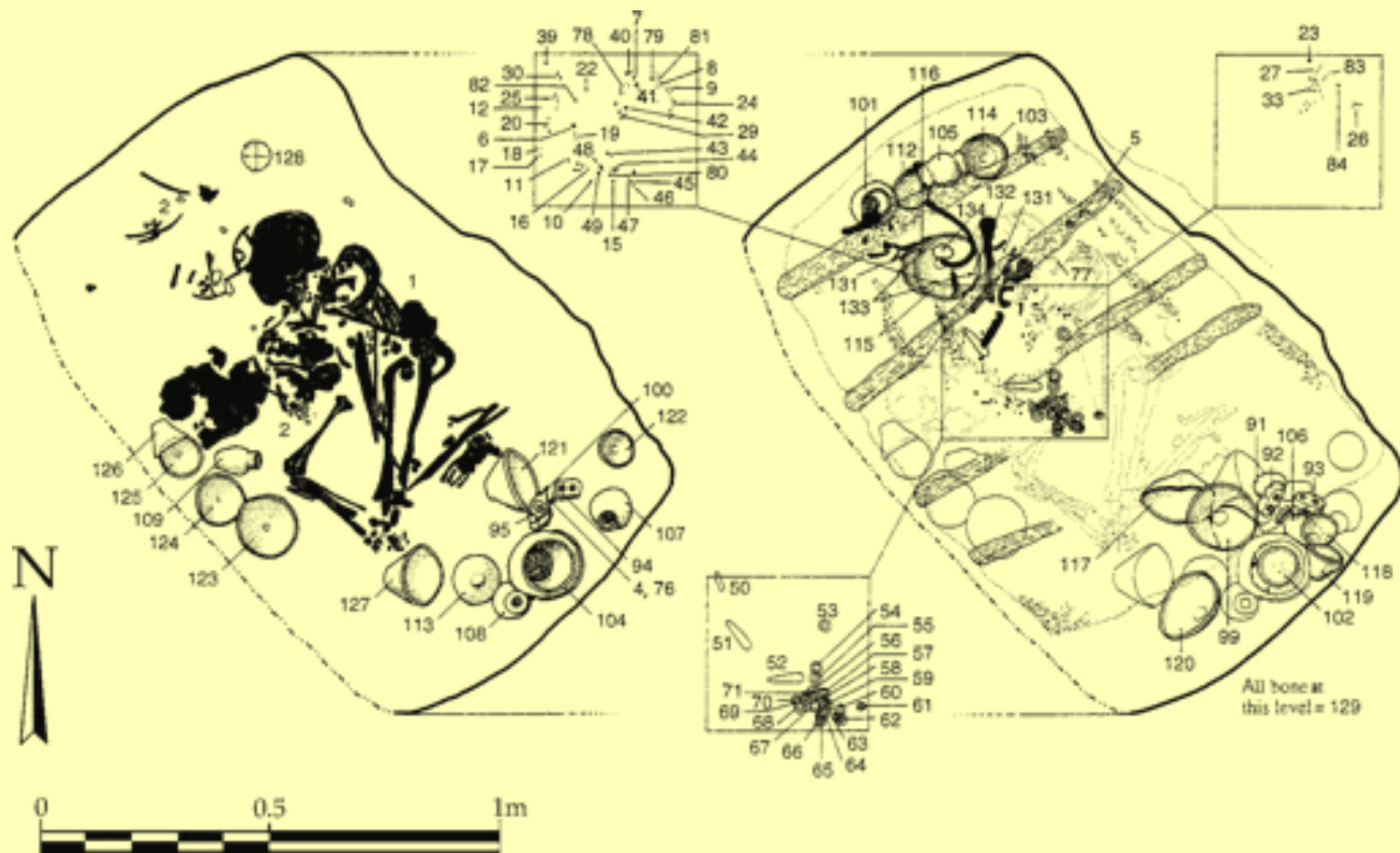

Junior grave goods in situ



Junior grave goods



Beads from Grave 246



The cupboard under the stairs



6H House, Level IB

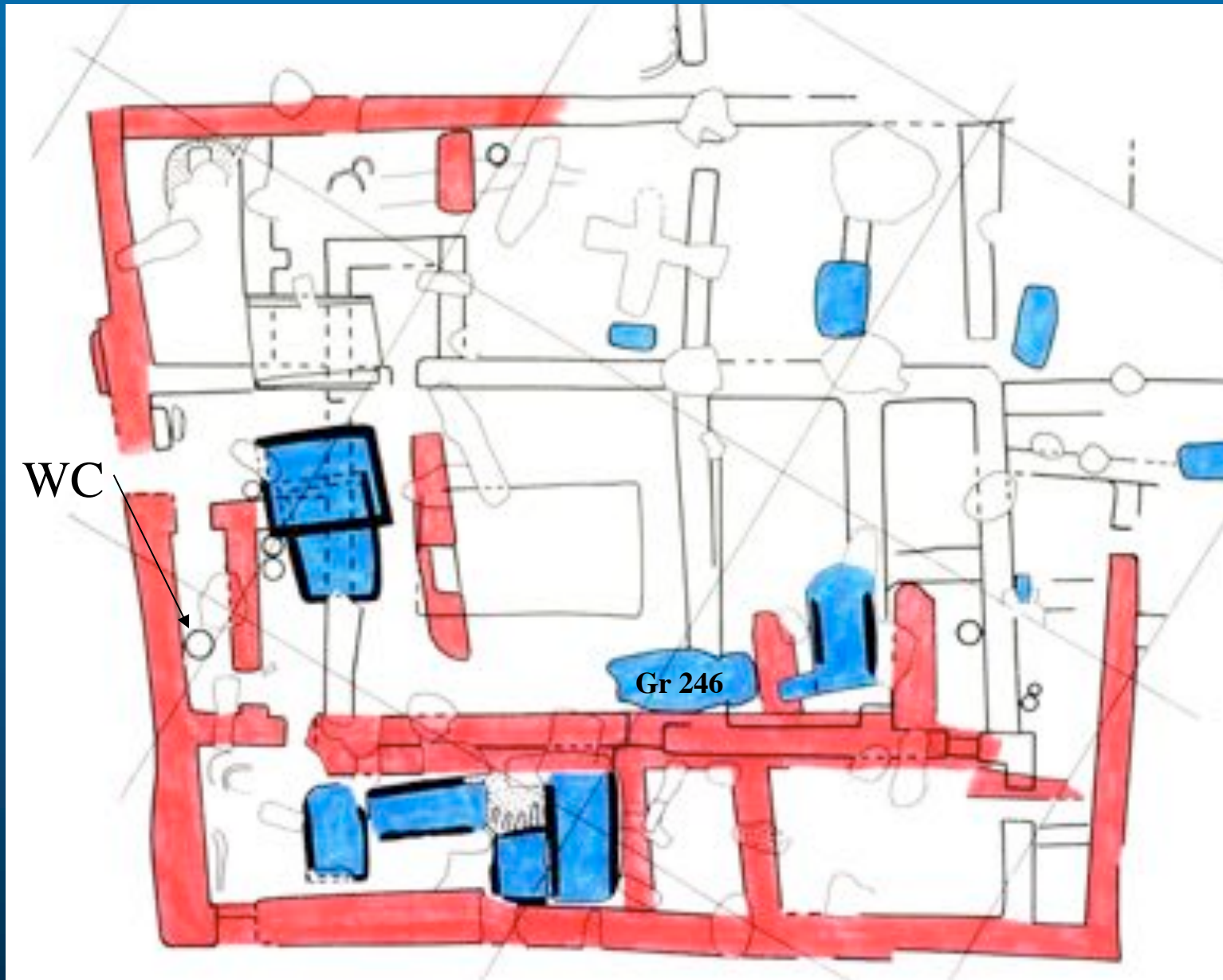

6H House

Helen McDonald and Addai emptying rooms



Vertical drain, aka sewer



A tight fit
(Addai down the drain)



Incantation interdicting intestinal indisposition

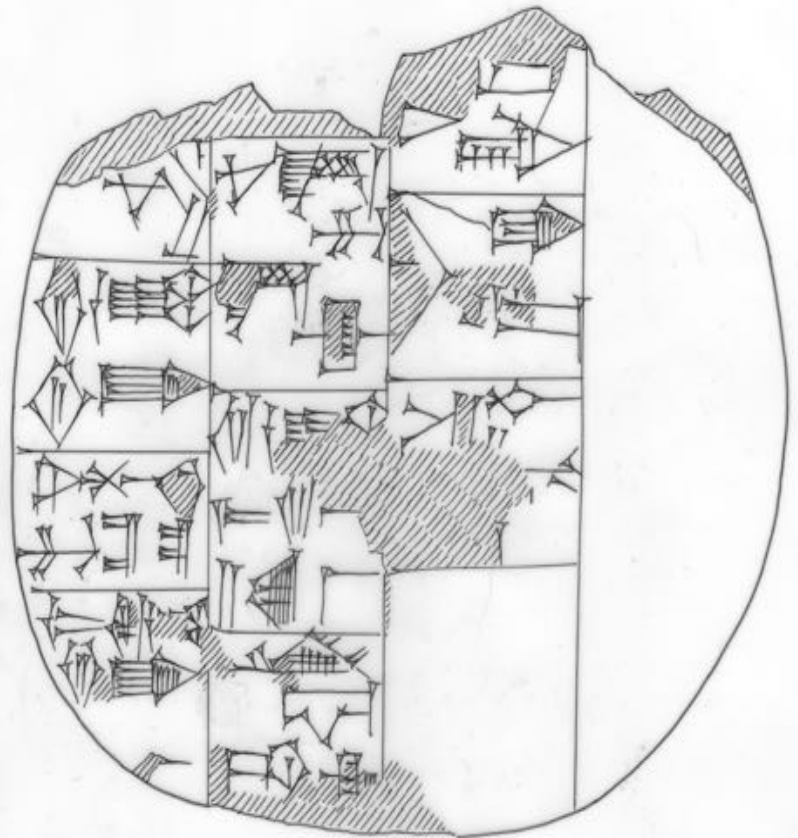

Grindstone fragments from kitchen

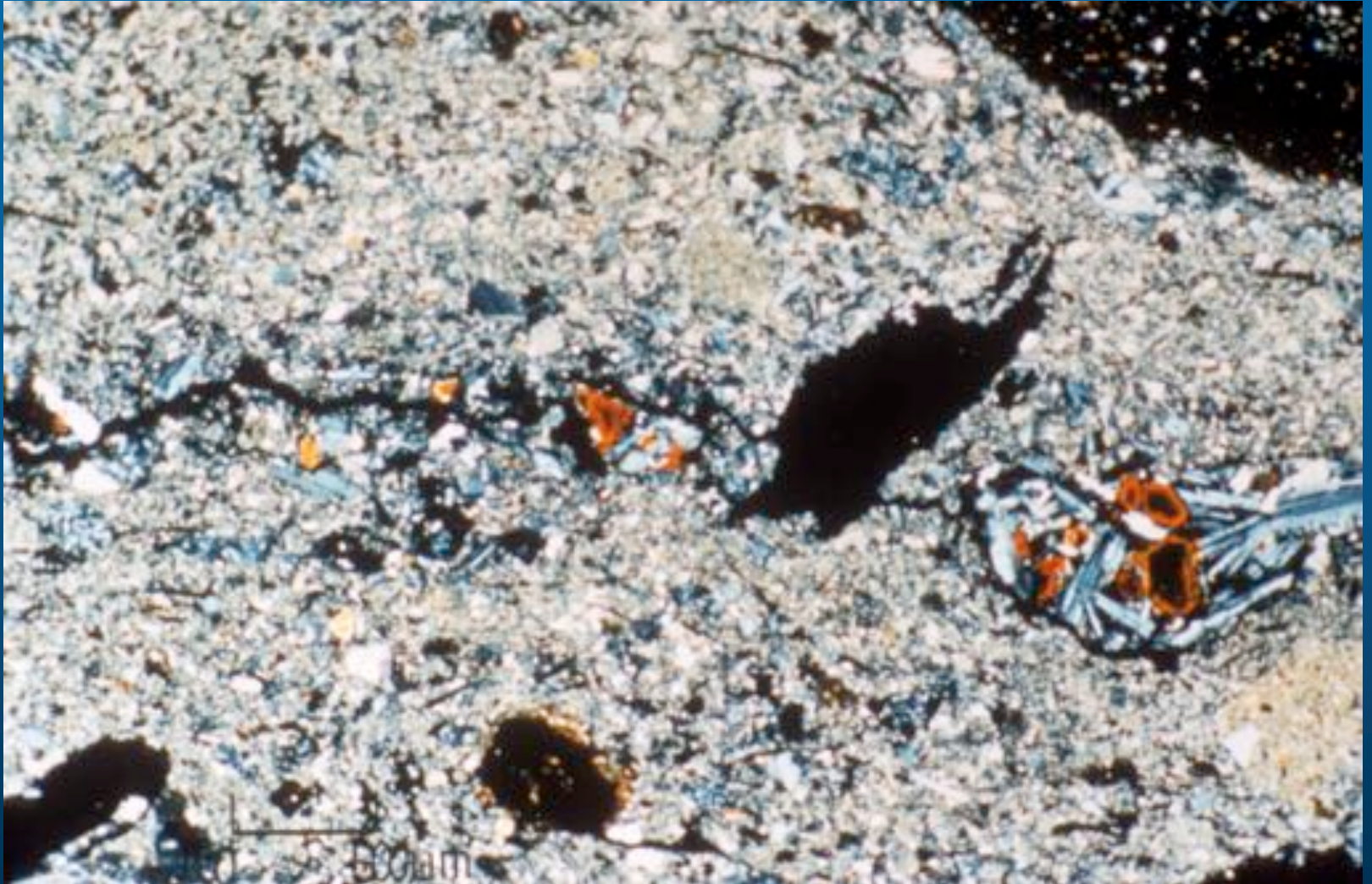



Use of urban space at Abu Salabikh

(Kate Spence dlv)

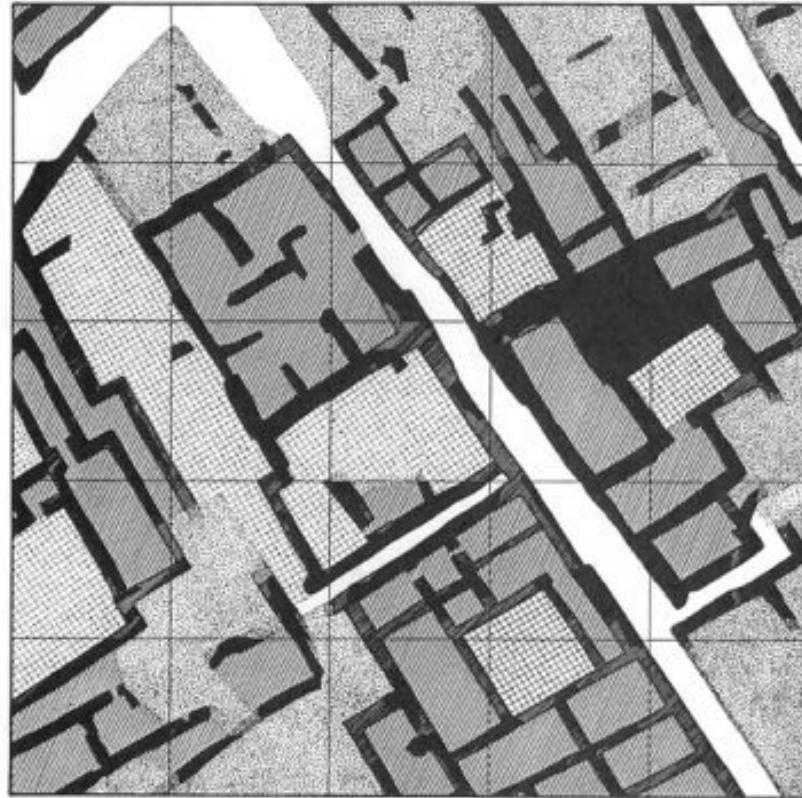

- Wall
- Wall, reconstructed
- Roofted space
- Courtyard
- Street or open space
- Wall/roofted space/courtyard

ABU SALABIKH

Area A

50 x 50m. sector
to show categories of space use



Breakdown of use of space from surface clearance

after CAJ 4, 53

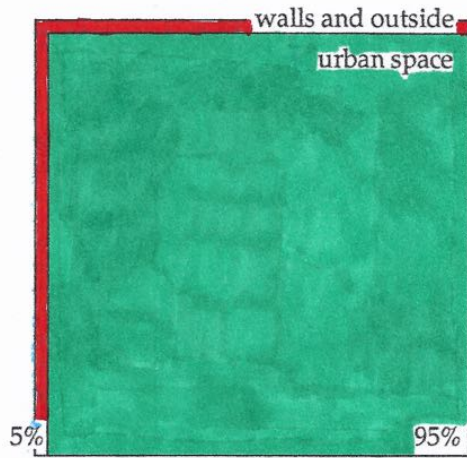

visible mound

city wall etc. 5%
urban space 95%

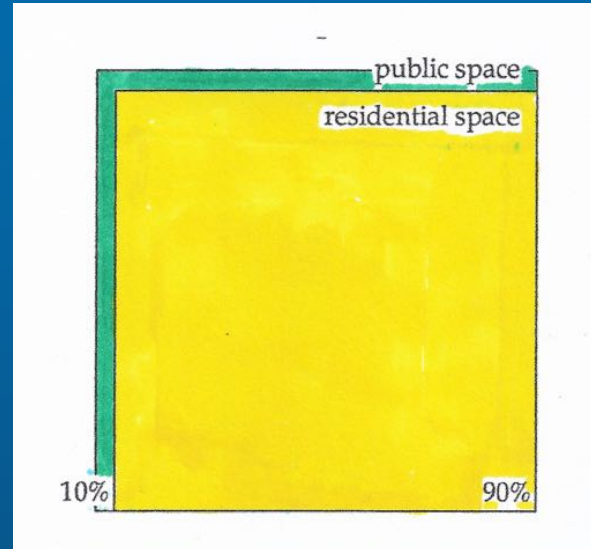

urban space

public space 10%
residential space 90%

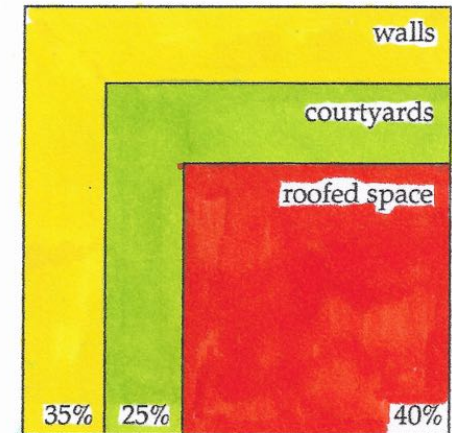

residential space

walls 35%
courtyards 25%
roofed space 40%

Green sherds, red sherds



Interior of pottery firing pit



Later occupation at the north end



Kiln rake-out on one of the floors
in potter's house





Potter's disc in situ



and spruced up ...

Sealings from the potter's house



The top of the potter's grave





The potter in person?

The city plan in 1989

red: streets

orange: lanes

dark blue: city wall

light blue: city gates

green : rubbish tips



Kuwait 1990





Our thanks for the
pictures to:

Peter Barnes
Bob Bewley
Susan Coliton
Mark Dixon
Sal Garfi
David Loggie
David Nicolson
Jonathan Tubb
Chip Vincent
Marcus Woodburn

Abu Salabikh Excavations

The British School of Archaeology in Iraq

Field Directors and Assistant Directors

Jane Moon, Robert Killick, Roger Matthews, Nicholas Postgate

Sponsors



The British Academy

The British Museum

Birmingham City Museums

Manchester Museum

The National Geographic Society

The Royal Ontario Museum

C.H.W. Johns Fund

Trinity College Cambridge

The McDonald Institute

Bedr Abbas

Jeremy Black

Juliet Clutton-Brock

Rosemary Ellison

Iris Furlong

Tony Green

David Loggie

Roger Moorey

Joan Crowfoot Payne

Tony Wilkinson

Cuyler Young

The dig house, 2002



Inside the dig house, August 2002







Ahmed, Ahmed and co.





Destination Diwaniyah



Sorted and stored



Bones sorted, Diwaniyah May 2019



Jacob Jawdat, Eleuterio de Sousa, Tina Greenfield, Jane Gaastra

Real animals from the 6H House - 2019

6H -% of Identified taxa (n=2430)

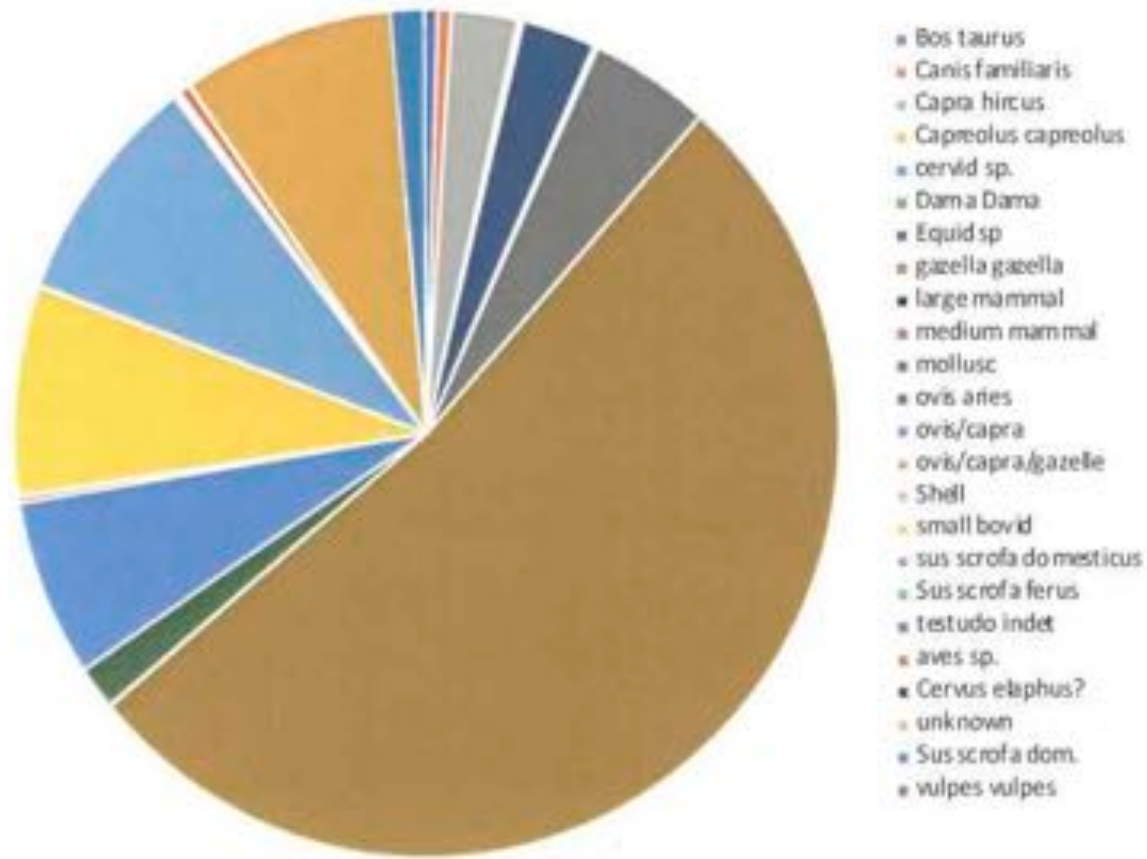

Still to do 2020



